



70
mm



7









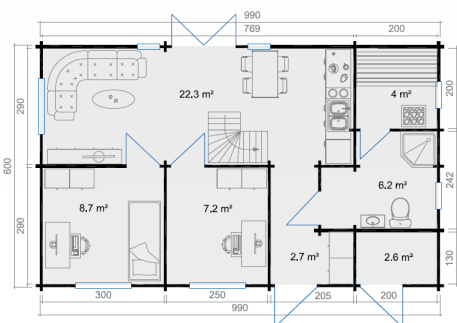

30



5
YEARS



VERPACKUNG: 10 PALETTE(N)

-  109 x 20 x 10 cm
63 kg
-  650 x 114 x 85 cm
1843 kg
-  650 x 114 x 85 cm
1843 kg
-  650 x 114 x 85 cm
1843 kg
-  650 x 114 x 85 cm
1843 kg
-  650 x 114 x 85 cm
1843 kg
-  390 x 114 x 85 cm
1106 kg
-  390 x 114 x 85 cm
1106 kg
-  200 x 114 x 85 cm
567 kg
-  200 x 114 x 85 cm
567 kg

DIMENSIONEN

| | |
|-----------------|----------------|
| Fläche | 102.80 m2 |
| Dachabmessungen | 7.00 x 10.00 m |
| Rauminhalt m3 | ≈ 247.0 m3 |
| Seitenwandhöhe | ≈ 4.15 m |
| Firsthöhe | ≈ 4.96 m |
| Vordach | ≈ 50 cm |

FENSTER & TÜR

| | |
|-------------------------------------|------------------|
| 1 x Doppeltür | 158.0 x 200.0 cm |
| 1 x Einzeltür | 72.7 x 185.6 cm |
| 2 x Einzeltür | 79.0 x 167.6 cm |
| 2 x Einzeltür | 104.0 x 200.0 cm |
| 3 x Einzeltür | 82.7 x 200.0 cm |
| 2 x Einzelfenster öffnet nach innen | 91.6 x 91.6 cm |
| 2 x Einzelfenster öffnet nach innen | 65.0 x 65.0 cm |
| 2 x Einzelfenster öffnet nach innen | 55.2 x 200.0 cm |
| 3 x Doppelfenster öffnet nach innen | 137.4 x 91.6 cm |

DACH UND FUSSBODEN

| | |
|--------------------------------|----------|
| Dachbretter | 15x90 mm |
| Fussbodenbretter | 15x90 mm |
| Dachfläche | 76.80 m2 |
| Dachwinkel | ≈ 22 ° |
| Imprägnierte Unterkonstruktion | 45x70 mm |

*Optional Dacheindeckung



